

Backyard Design

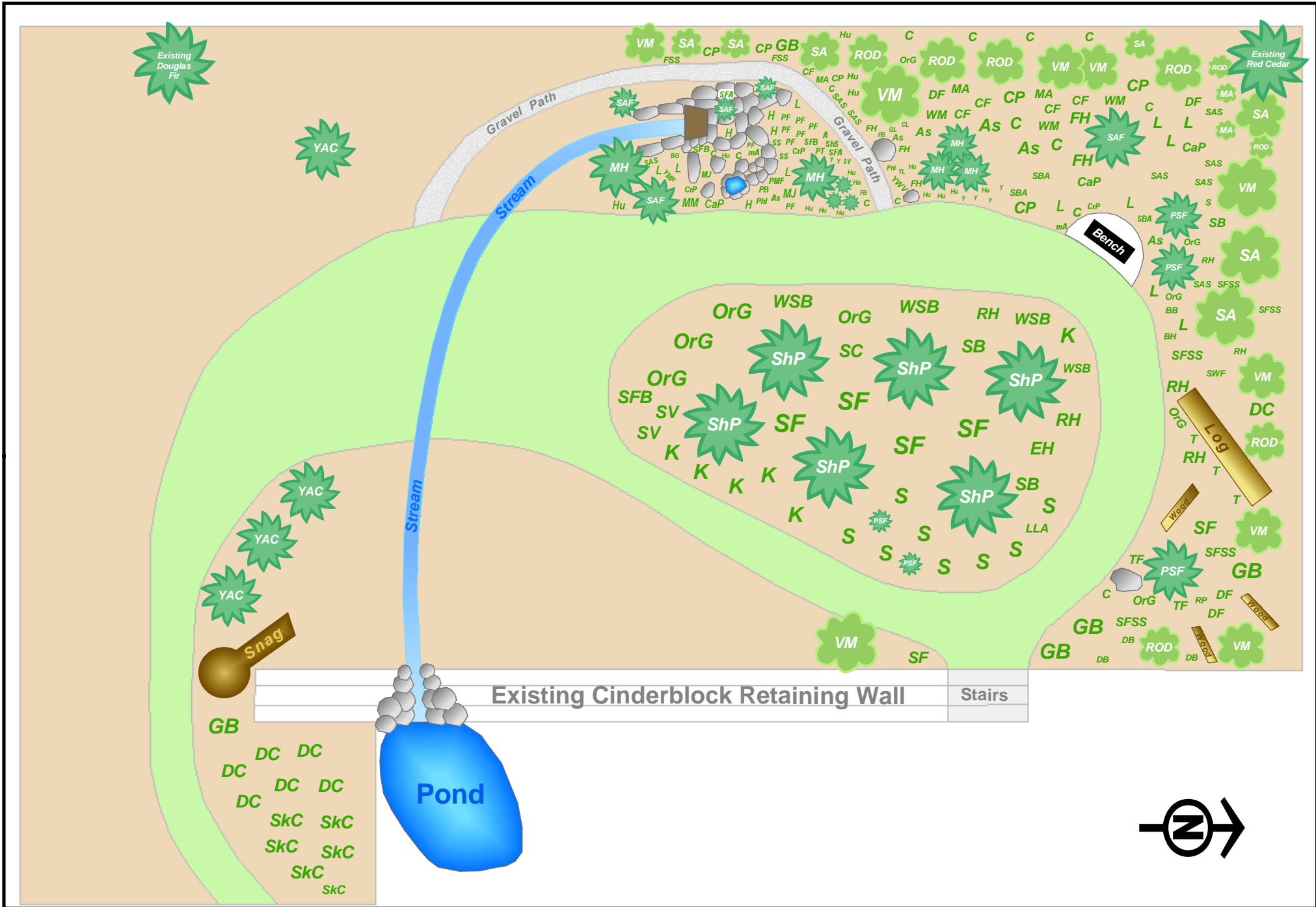

Code	Common Name	Scientific Name
A	Cut-leaf Anemone	<i>Anemone multifida</i>
As	Aster	<i>Aster modestus</i>
		<i>Aster foliaceus</i>
		<i>Aster subspicatus</i>
BG	Beargrass	<i>Xerophyllum tenax</i>
BH	Bleeding Heart	<i>Dicentra formosa</i>
BB	Bunchberry	<i>Cornus Canadensis</i>
C	Red Columbine	<i>Aquilegia formosa</i>
CaP	Cascades Penstemon	<i>Penstemon serrulatus</i>
CF	Palmate Coltsfoot	<i>Petasites palmatus</i>
CL	Chocolate Lily	<i>Fritillaria lanceolata</i>
CP	Cow Parsnip	<i>Heracleum lanatum</i>
CrP	Cardwell's Penstemon	<i>Penstemon cardwellii</i>
DB	Dwarf Bramble	<i>Rubus lasiococcus</i>
DC	Devils Club	<i>Oplopanax horridus</i>
DF	Deer Fern	<i>Blechnum spicant</i>
DP	David's Penstemon	<i>Penstemon davidsonii</i>
EH	Evergreen Huckleberry	<i>Vaccinium ovatum</i>
FB	Fairybells	<i>Disporum hookeri</i>
		<i>Disporum smithii</i>
FH	False Hellebore	<i>Veratrum viride</i>
FSS	False Solomon's Seal	<i>Smilacina racemosa</i>
SFSS	Star-flowered False Solomon's Seal	<i>Smilacina Stellata</i>
GB	Goatsbeard	<i>Aruncus dioicus</i>
GL	Glacier Lily	<i>Erythronium grandiflorum</i>
H	Pink Mountain Heather	<i>Phyllodoce empetriformis</i>
Hu	Mountain Huckleberry	<i>Vaccinium membranaceum</i>
	Cascade Huckleberry	<i>Vaccinium deliciosum</i>
	Akaskan Blueberry	<i>Vaccinium alaskaense</i>
	Oval-leaved Blueberry	<i>Vaccinium ovalifolium</i>
K	Kinnikinnick	<i>Arctostaphylos uva-ursi</i>
L	Lupine	<i>Lupinus pollyphyllus</i>
		<i>Lupinus latifolius</i>
LF	Licorice Fern	<i>Polypodium glycyrrhiza</i>
LLA	Large-leaved Avens	<i>Geum macrophyllum</i>
mA	Mountain Avens	<i>Dryas Octopetala</i>
MA	Mountain Ash	<i>Sorbus sitchensis</i>
		<i>Sorbus scopulina</i>
MH	Mountain Hemlock	<i>Tsuga mertensiana</i>
MJ	Mountain Juniper	<i>Juniperus communis</i>
MM	Broad-leaved Marsh Marigold	<i>Caltha biflora</i>

Code	Common Name	Scientific Name
OrG	Oregon Grape	<i>Mahonia nervosa</i>
		<i>Mahonia repens</i>
		<i>Mahonia aquifolium</i>
PB	Common Red Paintbrush	<i>Castilleja miniata</i>
Phl	Spreading Phlox	<i>Phlox diffusa</i>
PF	Partridgefoot	<i>Luetkea pectinata</i>
PMF	Pink Monkey-flower	<i>Mimulus lewisii</i>
PSF	Pacific Silver Fir	<i>Abies amabilis</i>
PT	Rosy Pussytoes	<i>Antennaria microphylla</i>
RH	Red Huckleberry	<i>Vaccinium parvifolium</i>
ROD	Red Osier Dogwood	<i>Cornus stolonifera</i>
RP	Rattlesnake Plantain	<i>Goodyera oblongifolia</i>
S	Salal	<i>Gaultheria shallon</i>
SA	Sitka Alder	<i>Alnus sinuata</i>
		<i>Alnus tenuifolia</i>
SAF	Subalpine Fir	<i>Abies lasiocarpa</i>
SAP	Subalpine Spirea	<i>Spirea densiflora</i>
SB	Snowberry	<i>Symphoricarpos albus</i>
SBA	Streambank Arnica	<i>Arnica amplexicaulis</i>
SC	Shrubby Cinquefoil	<i>Potentilla fruticosa</i>
SD	Subalpine Daisy	<i>Erigeron peregrinus</i>
SF	Sword Fern	<i>Polystichum munitum</i>
SFA	Small-flowered Alumroot	<i>Heuchera micrantha</i>
SFB	Showy Fleabane	<i>Erigeron speciosus</i>
ShP	Shore Pine	<i>Pinus contorta var. contorta</i>
ShS	Showy Sedge	<i>Carex spectabilis</i>
SkC	Skunk Cabbage	<i>Lysichitum americanum</i>
SS	Few-flowered Shootingstar	<i>Dodecatheon pulchellum</i>
SWF	Spiny Wood Fern	<i>Dryopteris expansa</i>
SV	Sitka Valerian	<i>Valeriana sitchensis</i>
T	Western Trillium	<i>Trillium ovatum</i>
TF	Twinflower	<i>Linnaea borealis</i>
TL	Tiger Lily	<i>Lilium columbianum</i>
VM	Vine Maple	<i>Acer circinatum</i>
WSB	Woodland Strawberry	<i>Fragaria vesca</i>
WM	Western Meadowrue	<i>Thalictrum occidentale</i>
Y	Yarrow	<i>Achillea millefolium</i>
YAC	Yellow Alaska Cedar	<i>Chamaecyparis nootkatensis</i>
YMF	Yellow Monkey-flower	<i>Mimulus guttatus</i>
YWV	Yellow Wood Violet	<i>Viola glabella</i>